

ACCESSORIES

ALUMINUM PROFILES

Made of Aluminum Extrusion

Standard Scope of Supply only includes the Profile

Standard Length is 2.5m long per piece.

Standard Finishes: Bright Silver Anodized (BSA), Bright Gold Anodized (BGA), Silver Anodized (SA), Gold Anodized (GA)

760-1

Shower Door Header

It is used to secure shower enclosure not reaching the ceiling.

Suitable Glass Thickness: 12mm (1/2") maximum.

Clear Vinyl and Snap-in filler insert might be needed for thinner glass than 12mm (1/2")

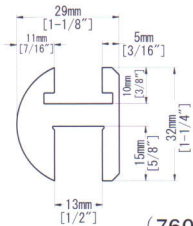

(760-1)

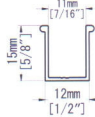

Snap-in Filler for glass thinner than 12mm (1/2")



Vinyl 70-23

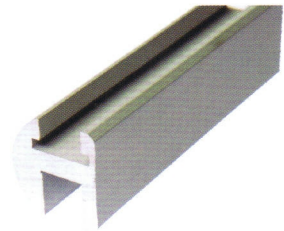

760-2

U channel for Fixed Panels.

Suitable Glass Thickness: 12mm (1/2") maximum

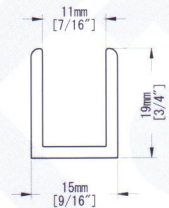
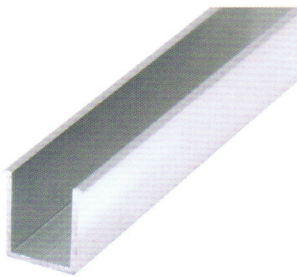

760-3

U channel for Swinging Doors

Vinyl Wipe 70-25 is to be inserted into the U channel 760-3.

For 10mm (3/8") thick glass.

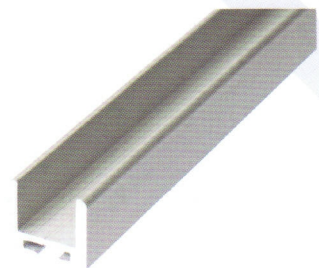
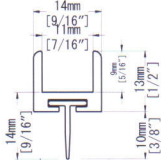

ACCESSORIES

770-1

Adaptor Block for Pivot Hinges to fix in Aluminum Header

Supplied with Screws.

Material: Solid Brass

Standard Finishes: CP (Bright Chrome), BN (Brushed Nickel), SCP (Satin Chrome), BSCP (Brushed Satin Chrome), AB (Antique Brass)

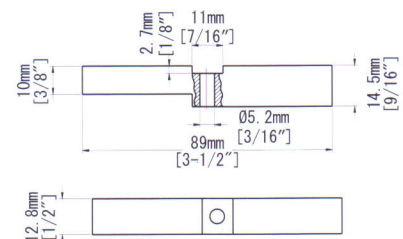
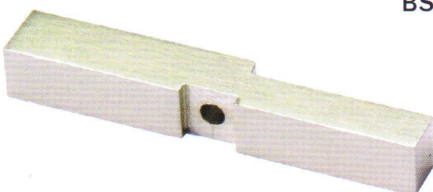

ACCESSORIES

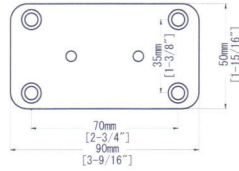

BP-F

Full Back Plate for Glass to Wall Hinge,
Finish matches Shower Door Hinges

BP-F1

Full Back Plate for Glass to Wall Hinge,
Finish matches Shower Door Hinges

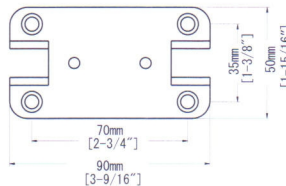
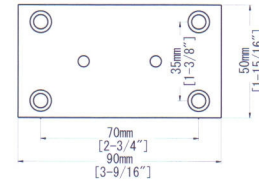

BP-H

H Back Plate for Glass to Wall Hinge,
Finish matches Shower Door Hinges

BP-H1

H Back Plate for Glass to Wall Hinge,
Finish matches Shower Door Hinges

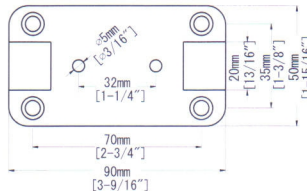
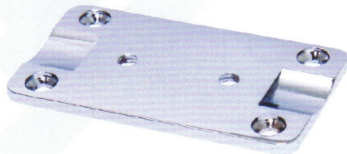
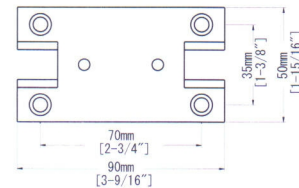
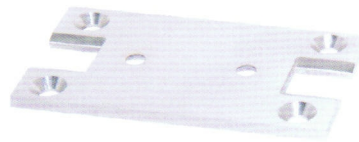

BP-U

U Back Plate for Glass to Wall Hinge,
Finish matches Shower Door Hinges

BP-U1

U Back Plate for Glass to Wall Hinge,
Finish matches Shower Door Hinges

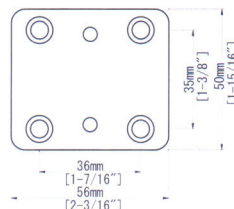
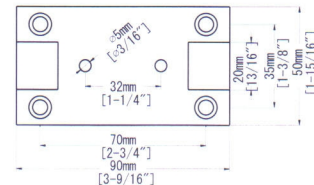

BP-S

Short Back Plate for Glass to Wall Hinge,
Finish matches Shower Door Hinges

BP-S1

Short Back Plate for Glass to Wall Hinge,
Finish matches Shower Door Hinges

